



# GRASSLANDS

Regina, Saskatchewan | [grasslands.ca](http://grasslands.ca)



RETAIL



DINING



HOTEL



RESIDENTIAL

## LEASING INQUIRIES

Colin Peter | 403.268.6640 | [cpeter@harvard.ca](mailto:cpeter@harvard.ca)  
Ryann Braaten | 306.777.0690 | [rbraaten@harvard.ca](mailto:rbraaten@harvard.ca)



# SITE AERIAL



## SITE ATTRIBUTES

SITE AREA	LEASABLE AREA	LARGE FORMAT RETAIL	URBAN VILLAGE
86 ACRES	950,000 SF	850,000 SF	100,000 SF

## MARKET INFORMATION

- Surrounded by the Albert Park and Harbour Landing neighbourhoods, Grasslands boasts a 5km trade radius of 60,000 people.
- Average household income; \$127,000
- Secondary Trade Area: 277,690 people
- Major employment and educational nodes nearby include: Regina International Airport, University of Regina, First Nations University of Canada, Saskatchewan Polytechnic.



# SITE PLAN

THE LANDING

NOW LEASING

FUTURE DEVELOPMENT



## TENANT LISTING

- 3. Meltwich
- BarBurrito
- Little Caesars
- Massage Experts
- Knight Archer Insurance
- 7. Mixed-Use Dev  
- 10,000 sq.ft
- 8. Future Residential Dev  
- 12,500 sq.ft
- 9. The Canadian Brewhouse
- 10. Quan's Hot Yoga
- Crème Café & Patisserie
- Bellezza Moda
- Romantic Nails & Spa
- The Cooperators
- YQR Dental Studio
- Regina Cornea Clinic
- Lindt
- Thai Express

- The Chopped Leaf  
For Lease - 1,200 sq.ft  
(Available October 2025)
- 11. Golf Town
- 12. Tommy Gun's Barbershop
- Factory Optical
- Cora Breakfast and Lunch
- 13. RBC Royal Bank
- 14. McDonald's
- 15. Popeyes Louisiana Kitchen
- The M:eating Room
- Designer Shoe Warehouse
- 16. Structube
- 17. Future Dev - 8,654 sq.ft
- 18. Olive Garden
- 19. Dairy Queen
- Subway
- 20. Urban Barn
- 21. Bulk Barn

- 22. Easy Financial
- Dr. Phone Fix
- Sizzling Wok
- Five Guys
- 23. Jump.ca
- Trifon's Mikes
- Sally Beauty
- Supplement King
- Carter's | OshKosh
- OPA! of Greece
- Ultracuts
- Trifon's Pizza
- COBS Bread
- 24. Bath & Body Works
- Penningtons
- La Vie en Rose
- Melanie Lyne
- 25. Sleep Country
- Ricki's

- 26. Scotiabank
- 27. Bass Pro Shops
- 28. Pro Hockey Life
- Marshalls
- 30. PetSmart
- Dollarama
- Laura
- Party City
- Lammle's Western Wear
- 33. Edo Japan
- Sasktel Store
- Willow Park Wines & Spirits
- 36. Mr. Mike's Steakhouse
- 38. Prairie Meats
- Bell Mobility
- For Lease - 1,241 sq.ft
- SportClips
- Booster Juice
- For Lease - 1,244 sq.ft

- Farmer Jane
- Chatters
- 39. FYiDoctors
- Grasslands Dental
- Leopold's Tavern
- 40. CIBC
- 41. Starbucks
- Amplifon
- 42. Tim Hortons
- 42B. Ricky's All Day Grill
- Future Dev - 2,000 sq.ft
- 43. Mr. Lube
- TacoTime



## REGINA, SK

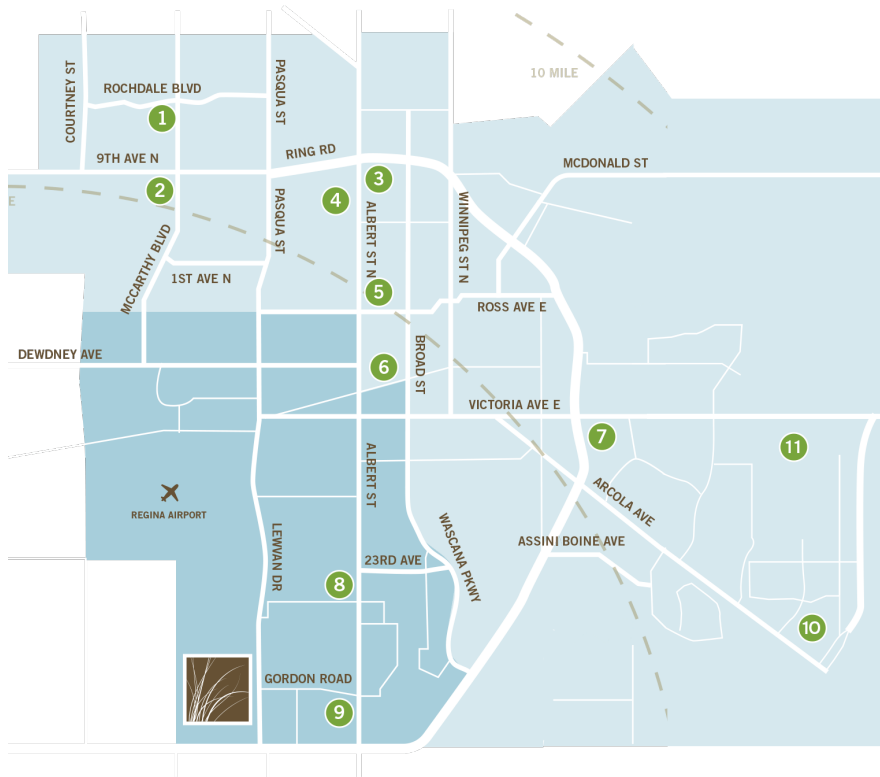

## RETAIL NETWORK

1. Rochdale Crossing
2. Normanview Crossing
3. Northgate Mall
4. Towers Mall
5. Carling Corner
6. Cornwall Centre
7. Victoria Square Mall
8. Golden Mile Mall
9. Southland Mall
10. Acre 21
11. Aurora



PRIMARY TRADE AREA (PTA) | 60,000 people



SECONDARY TRADE AREA (STA) | 250,000 people

## LOCATION INFORMATION

- High traffic location - Lewvan Drive, the Trans-Canada Highway and Gordon Road provide daily traffic of over 60,000 vehicles
- Highway #1 bypass makes Grasslands easily accessible from the Trans-Canada Highway

## “The Landing” at Grasslands

Grasslands is proud to boast ‘The Landing’, a vibrant community plaza in the heart of the shopping centre. This modern landscaped plaza is a community gathering hub for residents and visitors of the mixed-use property and offers a natural combination of greenery, walkway connections and seating areas.

With interactive and engaging events planned throughout the year, The Landing provides a one-of-a-kind experience that connects retailers, shoppers, and residents in a community atmosphere.

For more information visit [grasslands.ca/the-landing](http://grasslands.ca/the-landing).

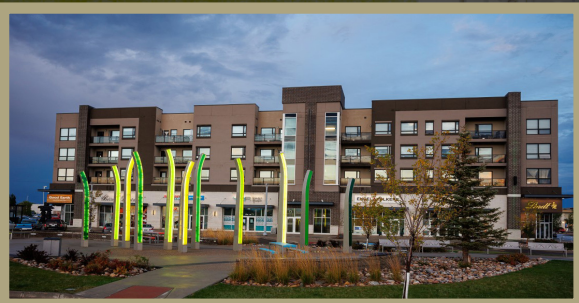

## LEASING INQUIRIES

Colin Peter | 403.268.6640 | [cpeter@harvard.ca](mailto:cpeter@harvard.ca)

Ryann Braaten | 306.777.0690 | [rbraaten@harvard.ca](mailto:rbraaten@harvard.ca)