

Located in the heart of Downtown, Hill Tower I is one of many recognizable staples in the Regina skyline. Situated on the corner of Scarth Street and 12th Avenue, Hill Centre I is a Class A office tower that was designed in conjunction with Hill Tower II. With a unique design and construction, these buildings boast inspirational architecture and high performance building systems.

BUILDING HIGHLIGHTS

- Connected to Regina's climate controlled pedway system which links to nine downtown office buildings, Casino Regina, The Delta Hotel & Convention Centre, and The Cornwall Centre
- Major tenants include MLT Aikins, Ministry of Justice, Yara Belle Plaine, Harvard Developments Corporation
- Excellent access to all major transit routes
- Close proximity to thriving downtown restaurants, retail, hotels, and Cornwall Centre
- Professionally managed and maintained by the Property Management team at Harvard Developments
- 24/7 live camera monitoring, security guard presence, card access system tied into front doors, elevators and tenants spaces linked to live cameras, safe walk programs, etc.

AVAILABLE SPACE

SUITE 100	6,197 SQUARE FEET
SUITE 102	663 SQUARE FEET
RENTAL RATE NEGOTIABLE	OP COSTS & PROPERTY TAXES \$18.22 PSF PER ANNUM

RYANN BRAATEN, SALESPERSON
LEASING MANAGER, HARVARD DEVELOPMENTS

T | 306.777.0600 **E** | rbraaten@harvard.ca

HILL CENTRE TOWER I
1874 SCARTH ST. | REGINA, SK

SUITE 100

6,197
SQUARE FEET

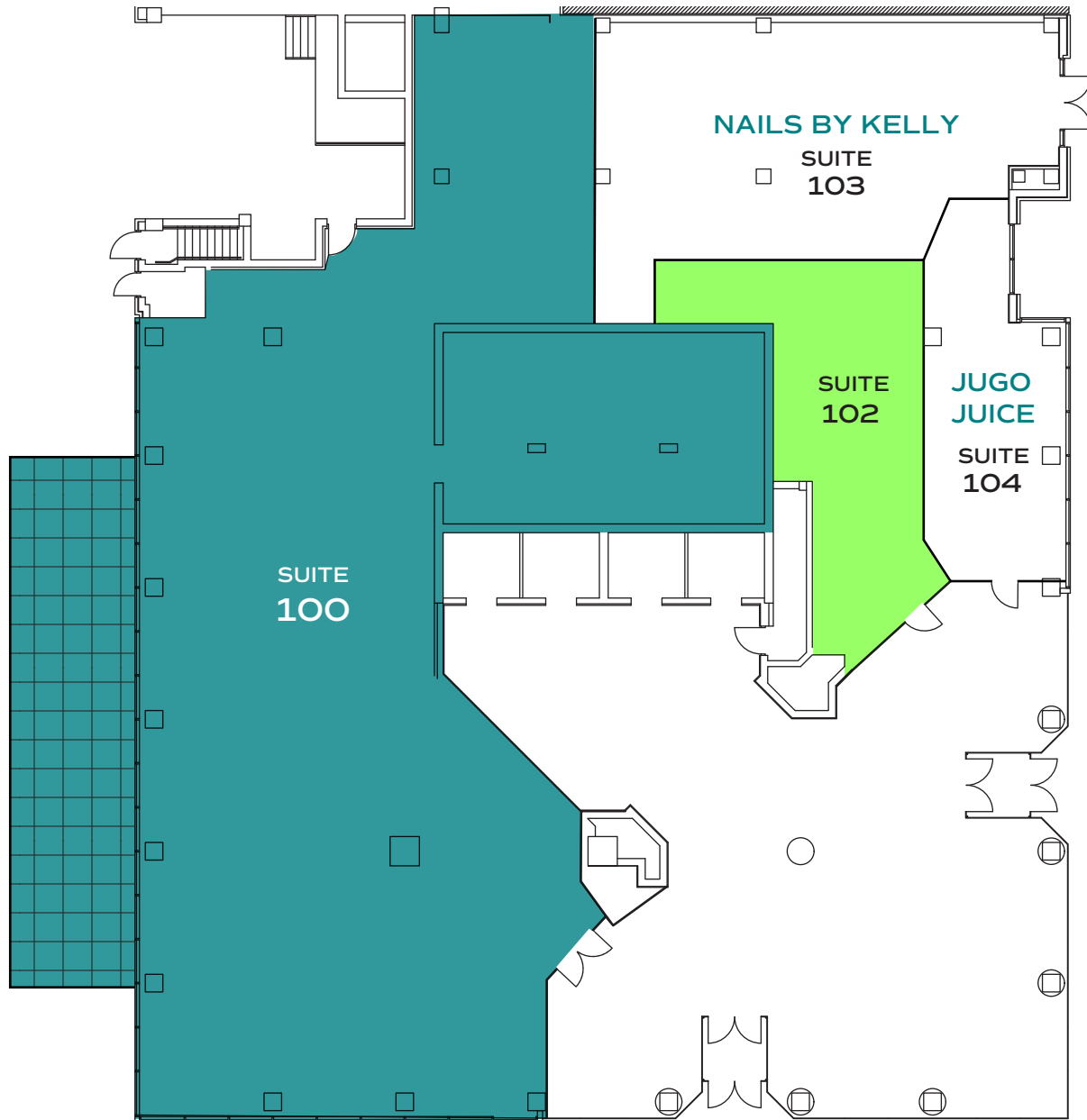

FLOOR PLAN IS APPROXIMATE



RYANN BRAATEN, SALESPERSON
LEASING MANAGER, HARVARD DEVELOPMENTS

T | 306.777.0600 E | rbraaten@harvard.ca

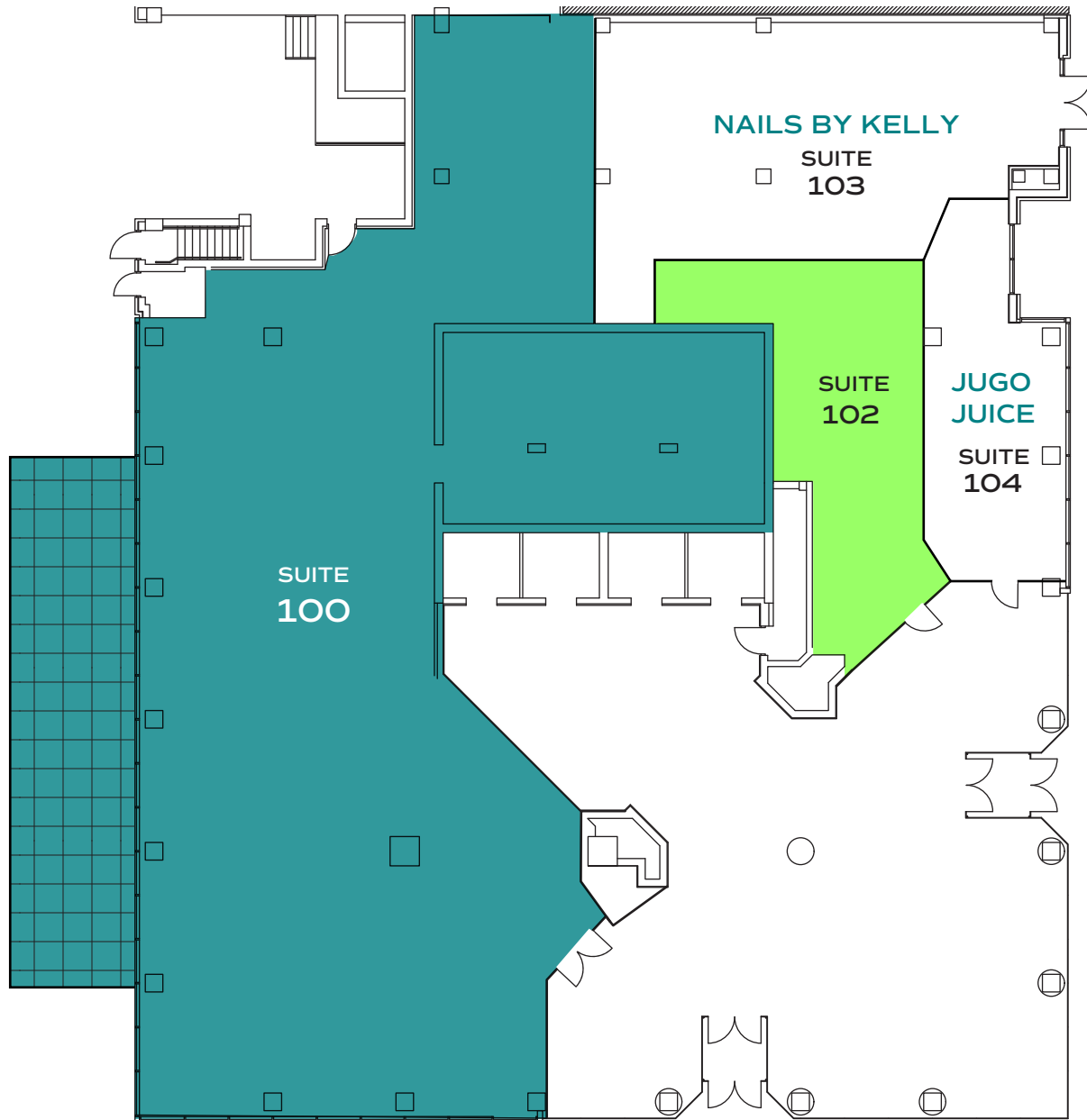

FLOOR PLAN IS APPROXIMATE